

**Hartest Parish Council**

**Survey of the trees on The Green**

In June, Hartest Parish Council commissioned a survey of the trees on The Green to assess any potential defects and management issues.

Attached are the results of the arboricultural appraisal by Mr Giles Hill of Land & Sculptural Design Partnership.

The management recommendations (Table: Rec. Works) are subject to amendment by Hartest PC, in line with the adopted Tree Safety Policy, and approval by Babergh District Council.

Note: trees T29 and T30 are property of Suffolk County Council (Highways) and ultimately their responsibility.

Dec 2017



# Land & Sculpture Design Partnership

LANDSCAPE ARCHITECTURE • ARBORICULTURE • SCULPTURE

## ARBORICULTURAL APPRAISAL

CLIENT : Hartest Parish Council

SITE : The Green, Hartest

JOB NO : LSDP 1014

DATE : October 2017

### CONTENTS:

1. INTRODUCTION
2. APPRAISAL

### 1. INTRODUCTION

**Background:** LSDP were appointed to prepare an arboricultural appraisal and strategy on behalf of Hartest Parish Council, with the objective of enhancing the contribution of the existing tree stock whilst addressing arboricultural conflicts with adjacent areas and identifying trees in poor physiological or structural condition to be removed.

The report is based on survey information collected during July and September 2017.

**The Site:** The Green is approximately triangular in shape and surrounded and overlooked by cottages and other period buildings of predominantly Tudor and Georgian character. The Green is bordered by the B1066 to the west and bisected by Shimpling Road to the south; other minor access tracks bisect the green in various places.

#### **The Trees:**

Thirty trees located on and adjacent to The Green were recorded in the survey; they appear to have been planted on a piecemeal basis and are growing as a mixture of groups and individual specimens.

### 2. APPRAISAL

**Generally:** The trees are recorded on the drawing overleaf and the schedules that follow; they are graded using a system similar to BS 5837: 2012, whereby the trees recorded as either 'A' (high value), 'B' (moderate value) and 'C' (low value) with the value judgement based on their arboricultural, landscape, cultural or conservation merit (see BS 5837: 2012 for further information).

The schedule includes comments about each tree and management recommendations, which are prioritised 1-4. The trees were surveyed from ground level applying Visual Tree Assessment methodology.





OCTAGON HOUSE . THE WATER RUN . HITCHAM . IPSWICH . SUFFOLK . IP7 7LN

T: 01449 740272 . E: LSDP@btinternet.com

**PARTNERS: GILES HILL BA (Hons) BLA CMLI • Tech Cert (Arbor. A.) • VANESSA HILL B.A. (HONS) M.A.**



**KEY:**

-  Tree of high arboricultural, cultural, or landscape value
-  Tree of moderate arboricultural, cultural, or landscape value
-  Tree of low arboricultural, cultural, or landscape value and / or trees with significant structural defects
-  Tree proposed for action (see Table)

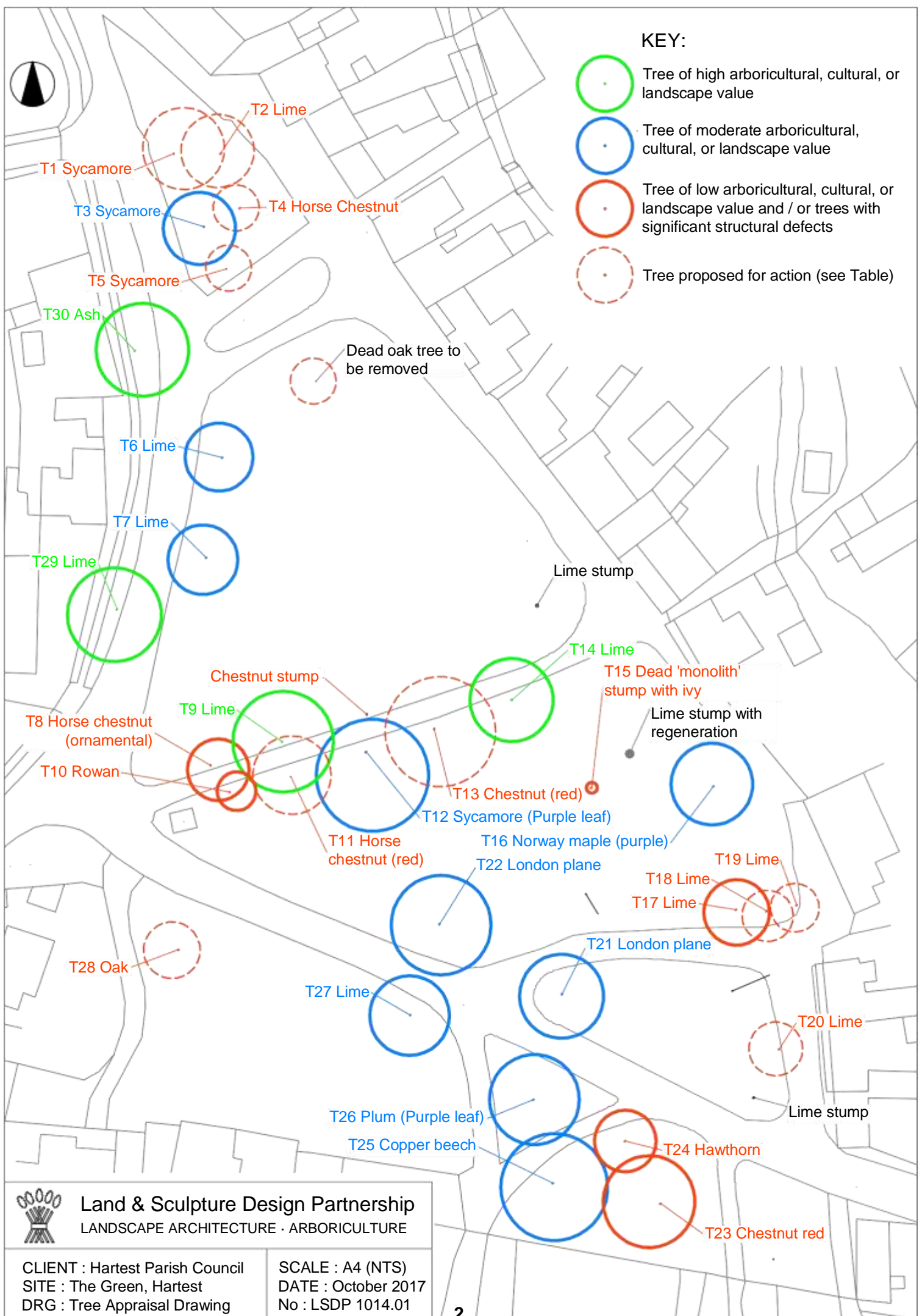

**Land & Sculpture Design Partnership**  
 LANDSCAPE ARCHITECTURE · ARBORICULTURE

CLIENT : Hartest Parish Council  
 SITE : The Green, Hartest  
 DRG : Tree Appraisal Drawing

SCALE : A4 (NTS)  
 DATE : October 2017  
 No : LSDP 1014.01

Tree Appraisal Schedule

The Green, Hartest

Ref	Species	Age Class	Grade	General observations	Rec. Works	Priority	TPO
T1	Sycamore	EM	B	Northernmost tree on green, located in narrow grass area. One of four trees recommended for removal to allow more 'traditional open green' appearance to northern area.	Fell, or re-pollard	3	P
T2	Lime	EM	C	Stem bifurcates at 4m height into co-dominant leaders. Adaptive growth below union. One of four trees recommended for removal to allow more 'traditional open green' appearance to northern area.	Fell, or re-pollard	3	P
T3	Sycamore	Ma	C	Pollarded at 4m height with regrowth above. Tree recommended for retention as long-term specimen managed pollard in open grass area	Re-pollard	3	P
T4	Horse chestnut	Ma	C	Pollarded at 4m height with regrowth above. One of four trees recommended for removal to allow more 'traditional open green' appearance to northern area.	Fell, or re-pollard	3	P
T5	Sycamore	Ma	C	Pollarded at 4m height with regrowth above. One of four trees recommended for removal to allow more 'traditional open green' appearance to northern area.	Fell, or re-pollard	3	P
T6	Lime	EM	B	Roadside tree. Large deformed root buttress apparently associated with girdling root. This may cause structural problems in future years as a result of 'included bark' at the base of the tree and should be reviewed every 3-5 years.	Monitor	3	N
T7	Lime	EM	B	Roadside tree, normal physiological condition, no significant defects.	Routine	4	N
T8	Horse chestnut (ornamental var)	Ma	C	Top grafted stem. Bark lacerations associated with bleeding canker on stem and main limbs, exposing sapwood. Horse chestnut timber is not resistant to decay and whilst trees are able to adapt to accommodate structural weaknesses, the ability of this species is to generate adequate 'repair' material through photosynthesis often hampered by horse chestnut leaf miner.	Monitor	3	Y
T9	Lime	Ma	A	Roadside tree, normal physiological condition, no significant defects.	Routine	4	Y
T10	Rowan	Ma	C	Suppressed tree	Routine	4	Y
T11	Horse chestnut (red flowered)	Ma	C	Ribbed stem and bark lacerations resulting from bleeding canker. Exposed sapwood with decay evident. Mature tree in declining condition, with significant structural defects, overhanging vehicular route across green. It may be feasible to retain the tree, subject to a more intensive inspection, to gauge thickness and extent of remaining undecayed wood, to inform ongoing management and reduce the risk of failure, however, given the tree's overall condition and limited contribution, it is recommended this tree be felled.	Fell	1	Y
T12	Sycamore (purple leaf)	Ma	B	Sparse growth on north side. Beginning to regenerate on this side, following loss of tree adjacent.	Routine	4	Y

Tree Appraisal Schedule

The Green, Hartest

Ref	Species	Age Class	Grade	General observations	Rec. Works	Priority	TPO
T13	Horse chestnut (red flowered)	Ma	C	Top graft with three leaders. Bark lacerations with exposed sapwood. Cavity on main stem resulting from loss of large limb. Decay evident in stem and main leaders. Mature tree in declining condition, with significant structural defects, overhanging vehicular route across green. It is recommended this tree be felled as per T11.	Fell	1	Y
T14	Lime	Ma	A	Roadside tree, normal physiological condition, no significant defects.	Routine	4	Y
T15	Unknown	Ma	C	Dead monolith stem approximately 4m high. Ivy clad. Monoliths provide valuable habitat for birds, bats and invertebrates. Their ongoing decay needs to be monitored to minimise risk of damage occurring; often they disintegrate over a period of time without presenting a hazard, but do need to be inspected either invasively, or by Picus for extent of basal decay.	Monitor	3	N
T16	Norway maple (purple leaf)	EM	B	Ornamental tree, normal physiological condition, no significant defects.	Routine	4	N
T17	Lime	Ma	C	Main stem previously pollarded at 6m height, multiple co-dominant leaders above this point that have been pollarded at 12m height	Re-pollard	3	Y
T18	Lime	Ma	C	Recently pollarded at 12m height.	Fell, or re-pollard	3	Y
T19	Lime	Ma	C	Recently pollarded at 12m height.	Fell, or re-pollard	3	Y
T20	Lime	Ma	C	Stem bifurcates 2,5m above ground level. Recently pollarded at approx 10m height.	Fell, or re-pollard	3	Y
T21	London plane	EM	B	Roadside tree, normal physiological condition, no significant defects.	Routine	4	N
T22	London plane	EM	B	Roadside tree, normal physiological condition, no significant defects.	Routine	4	N
T23	Horse chestnut (ornamental var)	Ma	C	Top graft with multiple leaders, some of which are missing. Decay in branch stubs	Monitor	3	N
T24	Hawthorn	Ma	C	Poor vigour and sparse canopy	Routine	3	N
T25	Copper beech	EM	B	Ornamental tree, normal physiological condition, no significant defects.	Routine	4	N
T26	Plum (Purple cherry-plum)	Ma	B	Ornamental tree, normal physiological condition, no significant defects.	Routine	4	N
T27	Lime	Ma	B	Roadside tree, normal physiological condition, no significant defects.	Routine	4	N
T28	Oak	Yo	C	Young tree planted below power lines, where there is insufficient space to accommodate significant additional growth.	Fell, or pollard	3	N
T29	Lime	Ma	A	Roadside tree previously pollarded at 6m height. Regrown leader with sub leader.	Routine	4	Y
T30	Ash	Ma	A	Roadside tree. Lapsed pollard with bole at 5m height with 5 leaders. Early signs of Chalara die-back.	Monitor	2	Y

## Tree Appraisal Notes and Abbreviations:

The information on the preceding schedule is recorded under the headings below:

- **Ref:** Identifies the location of each tree on the accompanying plan.
- **Species:** Common names are used.
- **Age Class:** Young – *Established but small, less than 1/3 of life completed, significant growth potential*; Early Mature – *Substantial tree, but with future growth potential: 1/3 - 2/3 of life completed*, Mature – *more than 2/3 of life completed, limited future growth potential*. Over Mature - *more than 2/3 of life completed and declining*, Veteran – *Veteran trees have no precise definition but are trees considered to be of biological aesthetic or cultural value because of their age*.
- **Grade:** Based on BS5837: 2012 subcategories 1-3: A – *Trees of high quality*; B - *Trees of moderate quality*, C – *Trees of low quality*.
- **General Observations:** Particularly relating to structural and/or physiological condition and/or preliminary management notes.
- **Recommended Work:** 'Routine' implies no management work is necessary, other than routine inspections. 'Monitor' implies that the condition of the tree is not cause for immediate concern, but that it's condition may quickly deteriorate due to a structural, and / or physiological condition that should be monitored and may require professional assistance. Generally, the other works are self-explanatory.
- **Priority:** 1 – Tree in obvious poor and declining condition, immediate attention required (i.e. within 12 months); 2 Trees requiring monitoring as outlined above; these should be inspected on annual basis and professional advice may be required within 3-5 years. 3. Trees requiring works within 5-7 years, typically this applies to the pollard trees. 4 Routine inspection only.
- **TPO:** The TPO schedule as not available and the following codes are based on a copy of the online location plan, whereby: N = No, the tree does not appear to be covered by TPO; Y = Yes the tree does appear... P = Possibly the tree is covered; i.e. one, or more of trees T1-T5 appear to be included, but it is unclear which are protected on the map.

The report was drafted in October 2017; the preceding management recommendations are likely to require reappraisal following any subsequent extreme weather events or changes to the environmental conditions of the trees – e.g. nearby excavation works etc.